

# Electric Chain Hoist

## 3-Phase

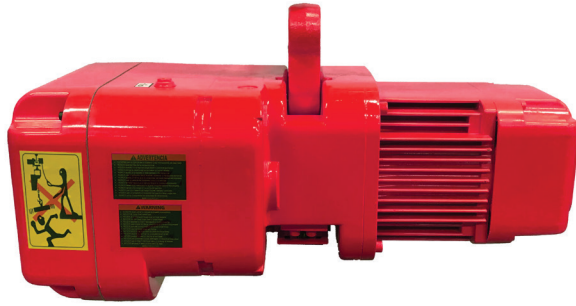

### Dual Voltage

All 3-phase hoists come standard from the factory wired for 460v power supply. This can easily be adjusted to 230v (or 208V 3-Phase).

### Overload Protection (friction clutch)

Prevents operators from exceeding a hoist's rated lifting capacity.

### Compact Aluminum Body

Die-cast body ensures a low headroom and lightweight construction.

### Operating Conditions

Suitable for environments within  $-4^{\circ}$  to  $+104^{\circ}$  F. Recommended Humidity of 85% or less.

### Pull-Rotor Motor Brake

Superior mechanical force ensures a load is firmly held. Contains no disc brake.

### Upper/Lower Limit Switches

Mechanical paddle limit switches.

### Pendant Control

Classic, robust design. 'ON' and red emergency stop push buttons are standard on all pendants. Pendant Cord includes external strain relief.

### Pendant & Power Plug Connection

Quick plug-in pendant controller cord and power cord.

### External Motor Fan

Rapidly cools the hoist motor and brake, forcing air through the cooling fins.

### Load Chain

Grade 80, case hardened FEC Japanese Chain. Now available in nickel-plated chain.

### Contactors Controlled

Mechanical interlocking contactors. 1 Million Operations.

### Chain Container

Included with all standard hoists.

### Phase Protection Relay

Hoist will not energize if the phase sequence is reversed. Relay status light indicates incorrect phase wiring sequence.

### Overload Relay

Precautionary feature, protects the motor from overheating.

### Quick Access Electrical Panel

Hoist electrical cover is tethered to hoist housing for maximum efficiency and convenience during inspection/ maintenance.

### Hinged Internal Electrical Panel

Easily inspect internal components and wiring behind contactors and din rail by opening the hinged electrical panel.

### Forged Swivel Bottom Hook

Rotate applications  $360^{\circ}$  during lifts. Safety latches are standard.

## Standard Trolley Specifications

### Beam Guide Rollers

Ensures the trolley wheels are safely aligned with the beams flange. Navigates curved beams.

### Yoke Coupling Connection

Minimizes headroom

### Flange Width

Fits 12-inch beam (shorter sizes available)

### Travel Speeds

Comes in either single or dual speed.

### Control Voltage

110v

### Duty Cycle

25% ED

## Standard Hoist Specifications

### Standard Voltage

230/460v 3 Phase 60 Hertz

### Ratings

Pendant: IP65 Hoist: IP55

### Standard Lift

20 Ft (custom lengths available)

### Standard Pendant Cord Length

17 Ft (custom lengths available)

### Standard Power Cord Length

15 Ft (custom lengths available)

### Duty Cycle

40% ED

### Chain Container

Canvas bag included with all standard hoists

### Capacity Range

1/2 – 10 Ton (Larger capacities available with longer lead times)

### Hoist Mounting

Rigid hook; motorized or manual trolley



**Dual Voltage**

Enables the hoist to operate on either 208v-230v or 460v. As standard, all hoists are wired for 460v. This can be simply adjusted to suit 230v power supply.



**Superior Load Chain**

Grade 80, FEC Japanese case hardened load chain. Optional nickel-plated chain.



**Quick Connect Plugs**

Optimizes maintenance and installation time.

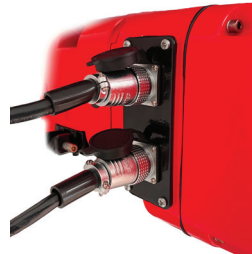

**Dual Speeds**

Dual speed models provide two speeds: fast and slow.



**Beam Profiles**

The unique design of the trolley wheels enable the trolley to operate on both W and S-Beams.

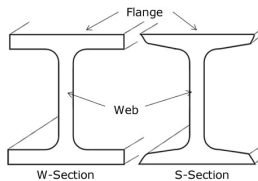

**Guide Rollers**

Ensures the trolley wheels are safely aligned with the beams flange. Navigates curved beams.

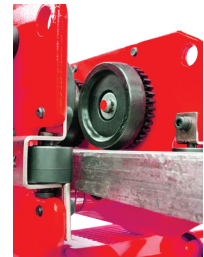

**Conditions**

All hoists are IP55 protected. Suitable for indoor use. Optional outdoor-rated hoists are available.

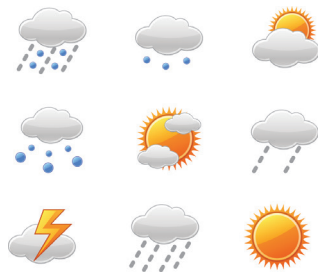

**Contactor Controlled**

Mechanical, interlocking Contactors.





### Standards

Complies with ANSI/ASME B30.13 Standards.

Load-tested to 125% of capacity.



### Heavy Duty Pendant

IP65 Pendant Controller. Designed to withstand heavy use in hardworking environments.



### Overload Protection

Friction clutch, prevents a hoist from lifting a weight beyond its safe workload.



### External Motor Fan

Rapidly cools the hoist motor and brake, forcing air through the cooling fins. This allows for greater hoist duty rating.



### Pull-Rotor Motor Brake

Reliable, robust. Contains no brake coil.

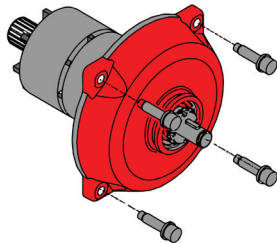

### Pocket Wheel

Smooth operation chain pocket wheel.

