

# BATTERY TRANSFER PLATFORM - BTC-PJ

APPROX WEIGHT: 288.41 lbs.  
DOES NOT INCLUDE WEIGHT OF POWER OR PACKAGING!!!

\*\*\* ANY ADDITIONS, DELETIONS, OR OMISSIONS MUST BE CORRECTED ON THIS DRAWING AS THIS DRAWING WILL BE CONSIDERED ALL INCLUSIVE \*\*\*

ALL GRAPHICS PROVIDED ARE FOR REFERENCE ONLY. IF CERTAIN DIMENSIONS ARE CRITICAL PLEASE VERIFY THOSE DIMENSIONS WITH YOUR SALESPERSON

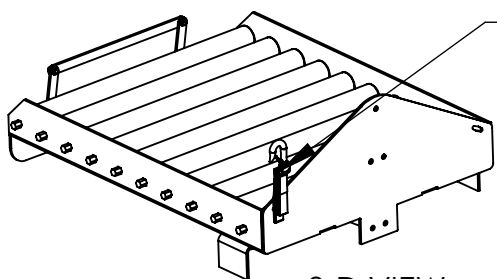

FORK TRUCK  
RESTRAINING  
STRAP CAN  
BE ATTACHED  
TO EITHER SIDE

3-D VIEW  
FOR REFERENCE

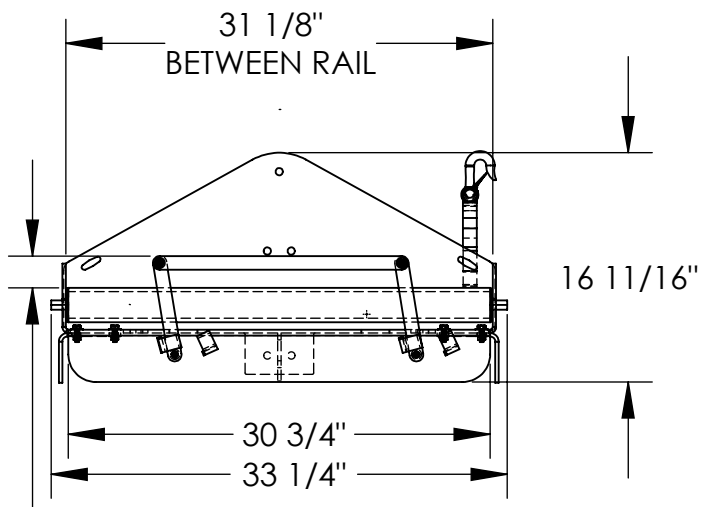
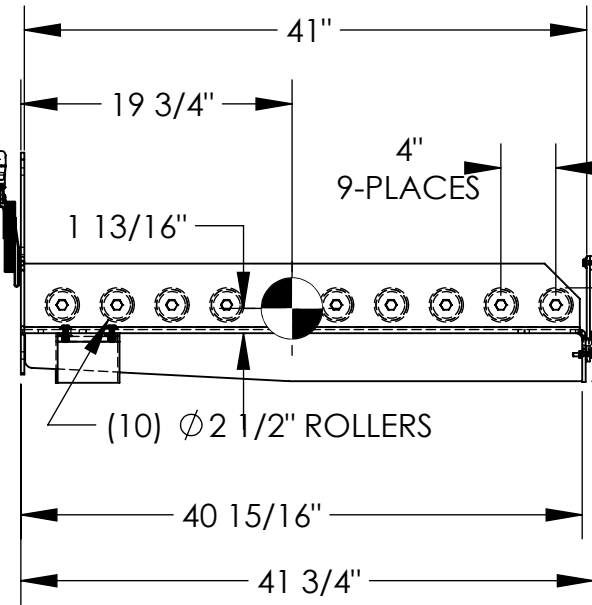
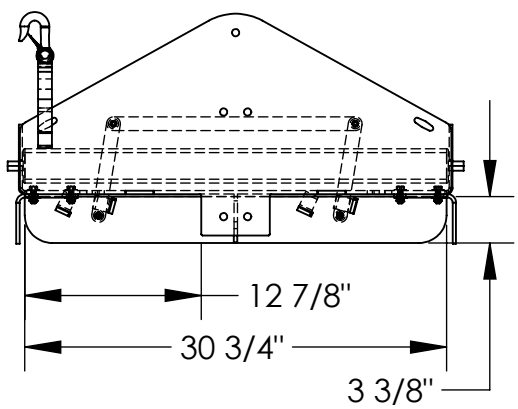

## STANDARD FEATURES

- MODEL NUMBER: BTC-PJ
- CAPACITY: 4,000 LBS
- USABLE WIDTH: 31 1/8"
- USABLE LENGTH: 41"
- OVERALL WIDTH: 33 1/4"
- OVERALL LENGTH: 41 3/4"
- OVERALL HEIGHT: 16 11/16"
- FLOOR TO TOP OF ROLLERS (EXCLUDING PALLET TRUCK): 6 13/16" (+/- 1/8")
- NUMBER OF ROLLERS: 10
- FORK OPENING WIDTH 12 7/8"
- FORK OPENING HEIGHT 3 3/8"
- DESIGNED TO ACCOMODATE MOST PALLET TRUCK
- TOUGH BAKED IN POWDER COAT YELLOW FINSH

## SPECIAL FEATURES

NONE

APPROX. WEIGHT / LOST LOAD = 288.41  
 MINIMUM EFFECTIVE THICKNESS =  
 FORK LENGTH - 40 15/16"  
 VERTICAL CENTER OF GRAVITY =  
 1 13/16"  
 HORIZONTAL CENTER OF GRAVITY =  
 19 3/4"

NEVER EXCEED LOAD CENTER  
 RATING PER FORKTRUCK  
 MANUFACTURERS GUIDELINES.  
 DO NOT USE THIS FORK TRUCK  
 ATTACHMENT IF LOAD WILL EXCEED  
 FORK TRUCK MANUFACTURER'S  
 LOAD CENTER RATING

DIMENSION TOLERANCE ± 1/4"

<b>APPROVAL</b>	I, THE UNDERSIGNED, AGREE THAT THE PRODUCT AS REPRESENTED SATISFIES DESIGN AND DIMENSION REQUIREMENTS. I ALSO ACKNOWLEDGE MY DUTY TO CONFIRM PRODUCT AND INSTALLATION COMPLIANCE WITH ALL APPLICABLE FEDERAL, STATE AND LOCAL REGULATIONS AND STANDARDS.	
	<b>UNITS REQUIRING APPROVAL DRAWINGS OR MODIFIED ARE NON-RETURNABLE</b>	
	[ ] As drawn      [ ] As marked	
	Signed: _____	Date: _____
Printed Name: _____		
<b>LEAD TIME WILL START UPON RECEIPT OF SIGNED APPROVAL DRAWING</b>		

DISTRIBUTOR'S NAME: <b>VESTIL MANUFACTURING</b>		P.O.# X
DRAWN BY: B.HORN		DATE: 08/12/2014
REFERENCE: X	SCALE: 1:14	SALES: X
QUOTED LEAD TIME: X	QUOTE # X	FILE NAME: 33-007-158