

HA Bolt-on Lifting Point

The HA bolt-on lifting point is a semi-permanent load attachment product designed for use as a fixed anchor in both lifting and lashing applications. Manufactured from alloy steel, the HA bolt-on lifting point delivers an excellent balance between toughness and ductility.

Standards: designed and manufactured in accordance with EN1677-1 and ASME B30.26.

Product sizes: available with working load limits from 2200 lbs to 11000 lbs.

Temperature: operational temperature range of -40°F to +392°F (-40°C to + 200°C) without reduction in working load limit.

Material: alloy steel.

Testing: load rated parts are subject to 100% magnaflux crack detection following heat treatment. HA lifting points are proof tested to 2.5 times working load limit, and fatigue rated to 1.5 times working load limit.

Bolts: recommended to use grade 10.9 or grade 12.9 bolts (bolts not included).

Safety factor: 4 : 1.

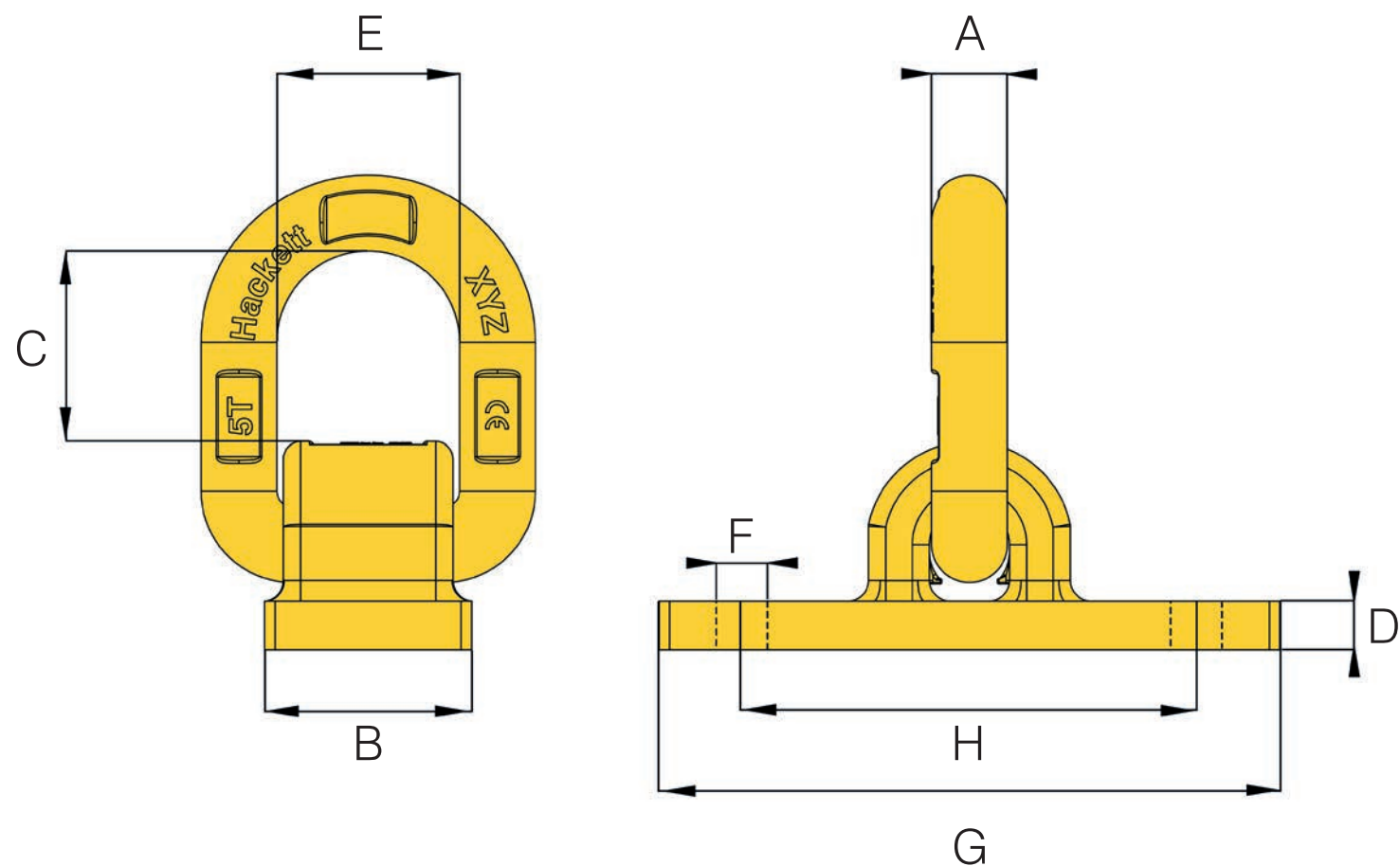

Imperial Specifications

PART CODE	WLL lbs	A inch	B inch	C inch	D inch	E inch	F inch	G inch	H inch	BOX QTY.	MASS lbs
8-H27-1T	2200	0.51	1.97	1.54	0.47	1.57	0.49	6.10	3.94	20	2.43
8-H27-3T	6600	0.67	1.97	1.85	0.63	1.77	0.65	6.10	3.94	10	3.53
8-H27-5T	11000	0.83	2.36	2.24	0.79	2.17	0.89	7.09	4.72	8	5.73