

HT-20-3036A INSTRUCTION MANUAL

BASIC DATA:

MODEL	CAPACITY	LOWERED HEIGHT	RAISED HEIGHT	TABLE DIMENSIONS	NET WEIGHT
HT-20-3036A	2,000LBS.	36"	54"	30" X 36"	313 LBS.

ASSEMBLY INSTRUCTIONS:

1. Put the frame on the ground, install outer guide posts (#15), and secure them with M8 bolts (#17), flat washer (#18) and lock nut (#20).
2. Install hydraulic cylinder on the frame, and secure it with 1/4-20 bolts (#57), washer (#58), & lock nuts (#59).
3. Remove solid plug on top end of the cylinder and replace it with bleeder (vent) plug to allow air to be bled from the hydraulic system.
4. Lift up the cylinder to ½" height, insert female side of extension rod (#56) on piston rod, and insert male side of extension rod in cylinder joint block (#6).
5. Install inner guide posts (#11) and secure them with M8 bolts (#14), spring washer (#13) and flat washer (#12).
6. Install push/pull handle (#1) on front side of the table (#5), and secure it with M8 bolts (#4), spring washer (#3) and flat washer (#2).
7. Adjust the verticality of inner guide post (#11) and outer guide post (#15) with the help of M8 bolt (#16)
- 8. Now tighten all bolts and nuts.**
9. Check all the parts, and then test this lift table with weight and without weight.

HT-20 Post Hydraulic Table

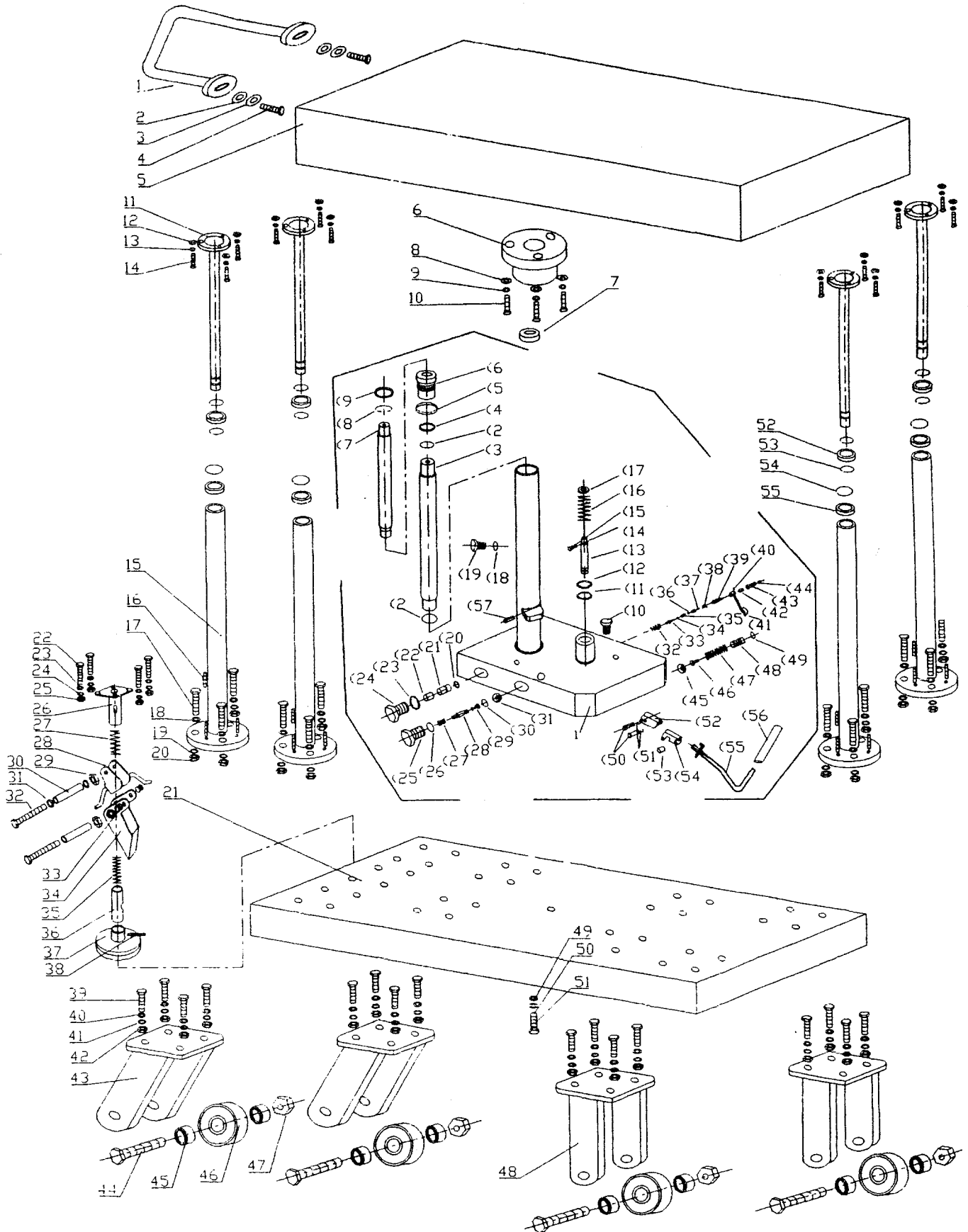

HT-20 Post Hydraulic Table

No.	Description	Q'ty	No.	Description	Q'ty	No.	Description	Q'ty
1	Handle	1	38	Spring Pin \varnothing 8×35	1	(20)	O-ring 9×1.8	1
2	Flat Washer	2	39	Hex Cap Bolt M10×30	16	(21)	Lowering Valve	1
3	Spring Washer	2	40	Flat Washer \varnothing 10	16	(22)	Washer \varnothing 12×8	1
4	Hex Cap Bolt	2	41	Spring Washer \varnothing 10	16	(23)	Washer \varnothing 14	1
5	Table	1	42	Hex Cap Nut M10	16	(24)	Screw Plug M14×1	1
6	Cylinder Joint Bolck	1	43	Swivel Wheel Holder	2	(25)	Set Screw	1
7	Round Nut	1	44	Hex Cap Bolt	2	(26)	O-ring \varnothing 16×2.4	1
8	Flat Washer \varnothing 8	3	45	Bearing	8	(27)	Spring	1
9	Spring Washer \varnothing 8	3	46	Wheel	4	(28)	Valve Core	1
10	Hex Cap Bolt M8×20	3	47	Hex Cap Nut M8	4	(29)	Valve Cover	1
11	Inter Guide Post	4	48	Fixed Wheel Holder	2	(30)	O-ring \varnothing 10×1.9	1
12	Flat Washer	12	49	Big Washer	1	(31)	Steel Ball \varnothing 7	1
13	Spring Washer	12	50	Spring Washer	1	(32)	Spring	1
14	Hex Cap Bolt M8×20	12	51	Hex Cap Bolt M12×20	1	(33)	Push Rod	1
15	Outer Guide Post	4	52	Separate Cover	4	(34)	O-ring \varnothing 15×2.4	1
16	Set Bolt M8×10	12	53	Steel Wire C-ring	8	(35)	Push Rod Cover	1
17	Hex Cap Bolt M8×35	12	54	Steel Wire C-ring	4	(36)	Guide Cover	1
18	Flat Washer	12	55	Separate Cover	4	(37)	Pin	1
19	Spring Washer	12	(1)	Valve	1	(38)	Spring	1
20	Hex Cap Nut	12	(2)	O-ring 32.5×1.8	2	(39)	Link Rod	1
21	Frame	1	(3)	Inter Cylinder	1	(40)	M6 Bolt	1
22	Hex Cap Bolt M8×20	4	(4)	Dust Cover DH28	1	(41)	Slice	1
23	Flat Washer	4	(5)	O-ring 56×3.5	1	(42)	Bushing	1
24	Spring Washer	4	(6)	Cylinder Cover	1	(43)	Bolt	1
25	Hex Cap Nut	4	(7)	Lift Piston	1	(44)	Nut	1
26	Brake Holder	1	(8)	O-ring 34×3.5	1	(45)	Steel Ball \varnothing 7	1
27	Spring	1	(9)	Dust Cover DH28	1	(46)	Spring Seat	1
28	Wave Arm	1	(10)	Hex Cap Bolt	1	(47)	Spring	1
29	Set Nut M8	1	(11)	Oil Seal UHS31.5	1	(48)	Set Screw	1
30	Pipe Cover	2	(12)	Dust Cover DH31.5	1	(49)	O-ring 10×1.9	1
31	Flat Washer	4	(13)	Pump Piston	1	(50)	Shaft	2
32	Hex Cap Bolt M8×55	2	(14)	Compose Washer \varnothing 4	1	(51)	C-ring	2
33	Screw \varnothing 8	2	(15)	Hex Cap Plug \varnothing 4	1	(52)	Rotate Block	1
34	Foot Pedal	1	(16)	Spring Seat	1	(53)	Press Wheel	1
35	Spring	1	(17)	C-ring \varnothing 15	1	(54)	Press Wheel Seat	1
36	Center Pipe	1	(18)	O-ring \varnothing 11×1.9	1	(55)	Foot Pedal Rod	1
37	Control Slice	1	(19)	Hex Cap Plug M10×1	1	(56)	Foot Pedal Cover	1