

KStrong® Aluminum and Steel Rolling Beam Anchor, Adjustable 3.14" - 9.84" (ANSI)

Model: UFA30130

KStrong® Aluminum and Steel Rolling Beam Anchor, adjustable to fit I-beams with flange widths ranging from 3.14" - 9.84" (ANSI)

DESIGN

- Anchor capable of being installed on flange of beams.
- Adjustment of the jaw to variable positions enables it to be installed to varying flange widths.
- Glides smoothly along the beam and provides horizontal mobility.

MATERIAL

Aluminum Alloy & Stainless Steel

MINIMUM BREAKING STRENGTH

Greater than 23 kN (5000 lbs.)

WEIGHT

8.94 lbs. \pm 0.22 lbs. (4055 gm \pm 100 gm)

RELEVANT STANDARDS

Meets or Exceeds ANSI Z359.18-2017 Type A

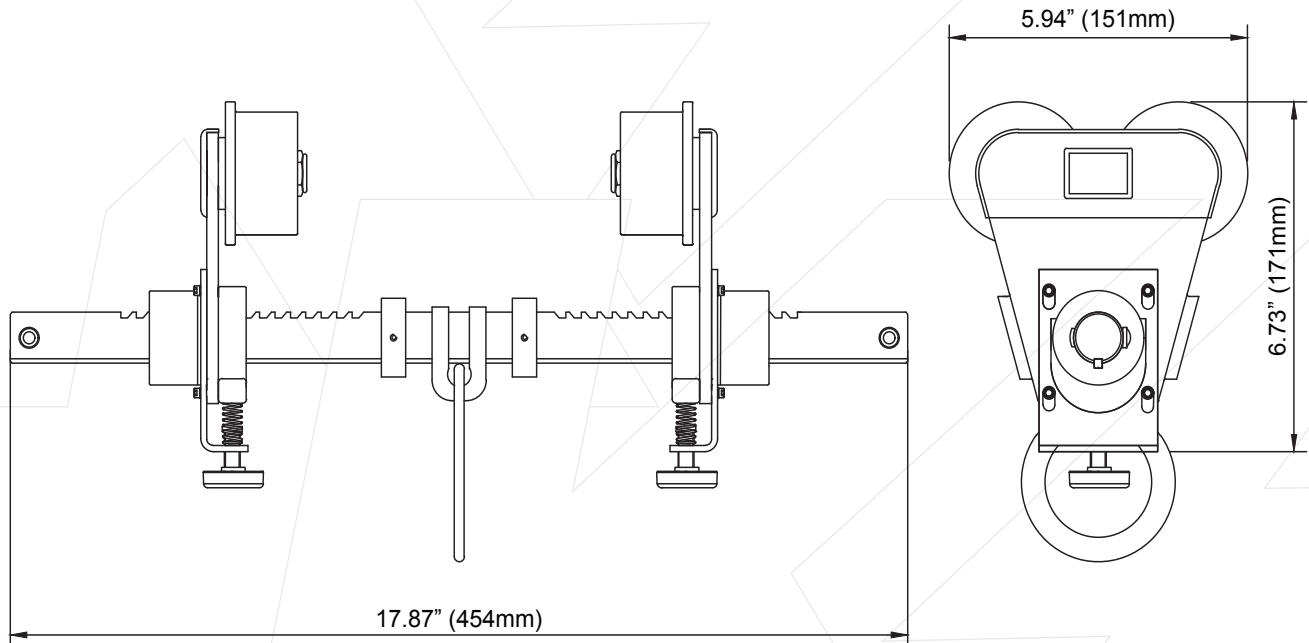

Meets or Exceeds ANSI Z359.18-2017 Type A