

# PLASTIC PALLET/SKID - PLPG-4848

APPROX WEIGHT: 56 lbs.  
 DOES NOT INCLUDE WEIGHT OF POWER OR PACKAGING!!!

\*\*\* ANY ADDITIONS, DELETIONS, OR OMISSIONS MUST BE CORRECTED ON THIS DRAWING AS THIS DRAWING WILL BE CONSIDERED ALL INCLUSIVE \*\*\*

ALL GRAPHICS PROVIDED ARE FOR REFERENCE ONLY. IF CERTAIN DIMENSIONS ARE CRITICAL PLEASE VERIFY THOSE DIMENSIONS WITH YOUR SALESPERSON

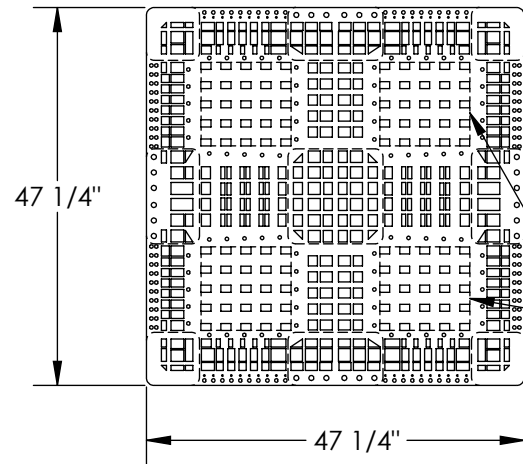

(4) SQUARE SECTIONS  
 ON BOTTOM OF PALLET  
 ARE OPEN - PALLET JACK  
 MAY BE USED FOR LIFTING

HOLE PATTERN MAY VARY

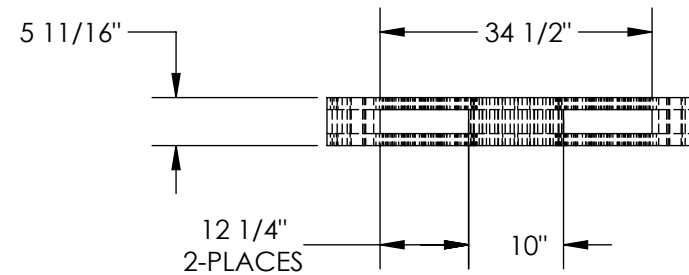
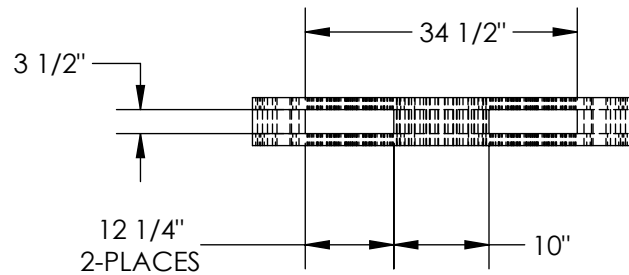
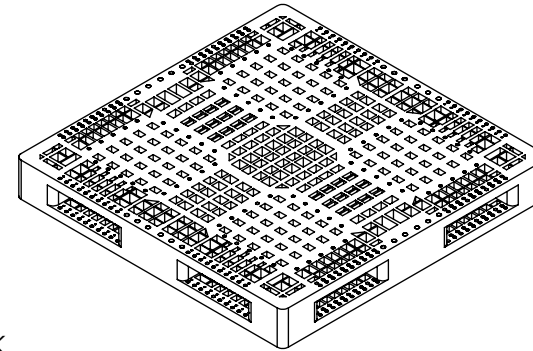

## STANDARD FEATURES

- MODEL NUMBER IS PLPG-4848
- OVERALL WIDTH IS 47 1/4"
- OVERALL LENGTH IS 47 1/4"
- OVERALL HEIGHT IS 5 11/16"
- INJECTION MOLDED, MATERIAL IS HIGH DENSITY POLYETHYLENE
- RACKABLE (FOR USE ON PALLET RACKS)
- STACKABLE FOR EFFICIENT STORAGE
- FLOOR (STATIC) WEIGHT CAPACITY IS 22,000 LBS.
- FORK (DYNAMIC) WEIGHT CAPACITY IS 3,900 LBS.
- UNSUPPORTED PALLET RACK WEIGHT CAPACITY IS 1,500 LBS.
- FORK OPENINGS (W X H) ARE 12 1/4" X 3 1/2"
- PALLET WEIGHT IS 56 LBS. APPROX.
- BLACK IN COLOR

## SPECIAL FEATURES

NONE

<b>A P P R O V A L</b>	I, THE UNDERSIGNED, AGREE THAT THE PRODUCT AS REPRESENTED SATISFIES DESIGN AND DIMENSION REQUIREMENTS. I ALSO ACKNOWLEDGE MY DUTY TO CONFIRM PRODUCT AND INSTALLATION COMPLIANCE WITH ALL APPLICABLE FEDERAL, STATE AND LOCAL REGULATIONS AND STANDARDS.	
	<b>UNITS REQUIRING APPROVAL DRAWINGS OR MODIFIED ARE NON-RETURNABLE</b>	
	[ ] As drawn      [ ] As marked	
	Signed: _____	Date: _____
Printed Name: _____		
<i>LEAD TIME WILL START UPON RECEIPT OF SIGNED APPROVAL DRAWING</i>		

DISTRIBUTOR'S NAME:		P.O.#
<b>VESTIL MANUFACTURING</b>		X
		W.O.#
DEY	DATE: 12/30/10	X
REFERENCE: X	SCALE: 1:24	FILE NAME:
QUOTED LEAD TIME: X	QUOTE #	PLPG-4848
	X	