

DELUXE ROLLER STAND, STAND-G-H-HP

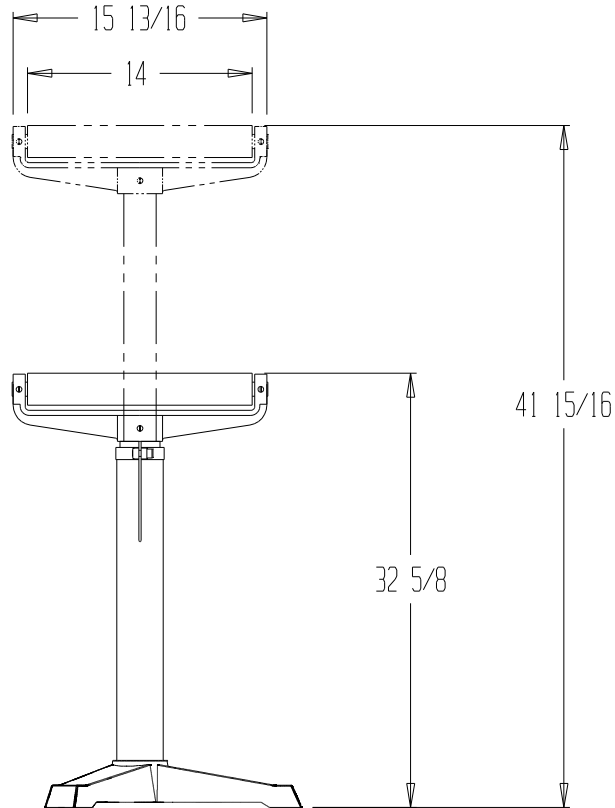
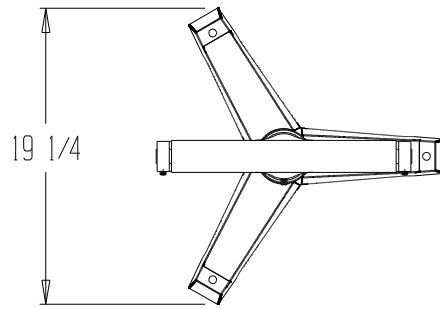

STANDARD FEATURES

- MODEL NUMBER: STAND-G-H-HP
- CAPACITY: 1760 LBS
- LOWERED HEIGHT(MIN): 32 5/8"
- RAISED HEIGHT(MAX): 41 15/16"
- 14" HORIZONTAL ROLLER
- HEAVY-DUTY CAST-ST'L BASE
- ADJUSTABLE HEIGHT
- ROLLER IS 2" DIA & CHROME PLATED

SPECIAL FEATURES

NONE

Any additions, deletions or omissions must be corrected on this drawing, as this drawing will be considered allinclusive.

All graphics provided are for reference only.
If certain dimensions are critical please
verify those dimensions with your salesperson

A P P R O V A L	I, THE UNDERSIGNED, AGREE THAT THE PRODUCT AS REPRESENTED SATISFIES DESIGN & DIMENSION REQUIREMENTS. I ALSO ACKNOWLEDGE MY DUTY TO CONFIRM PRODUCT & INSTALLATION COMPLIANCE WITH ALL APPLICABLE FEDERAL, STATE AND LOCAL REGULATIONS & STANDARDS.	
	UNITS REQUIRING APPROVAL DRAWINGS OR MODIFIED ARE NON-RETURNABLE	
	() As drawn () As marked	
	Signed: _____	Date: _____
Printed Name _____		
LEAD TIME WILL START UPON RECEIPT OF SIGNED APPROVAL DRAWING		

PRODUCTION WILL START UPON
RECEIPT OF SIGNED APPROVAL
DRAWING

- **SPECIAL UNITS ARE NON-RETURNABLE
- *AVAILABLE AT ADDITIONAL COSTS

DISTRIBUTOR'S NAME: VESTIL MANUFACTURING		P.O.#: -
DRAWN BY: TAL		DATE: 2/8/2024
REFERENCE: -	SCALE: 1:12	SALES: -
QUOTED LEADTIME: -	QUOTE #: -	DRWG./FILE NAME: STAND-G-H-HP