

Model AST

Non-Locking Type

Both the **Model AST and ASTL** were developed primarily for lifting, turning and stacking lightweight beams and structural shapes while a constant tension is applied to the lifting shackle. The horizontal shackle permits a beam to be lifted with the web in a near horizontal position by placing the clamp on the load with the shackle positioned over the web, and between the flanges. With a beam lying in a horizontal position, and the clamp placed with the shackle overhanging the flange, the beam can be lifted, turned 90°, and raised in a vertical position.

Permits beam to be lifted in a near horizontal position.

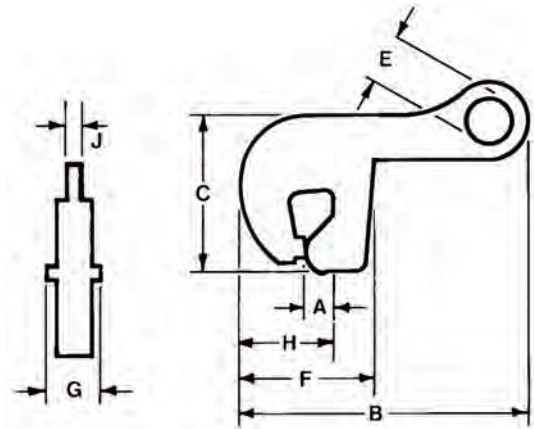

MODEL AST SPECIFICATIONS (in inches)

| Part Number | Plate Thickness A | Max. B | C | D | E | F | G | H | J | Weight (lbs.) |
|----------------------------|-------------------|--------|---------|---|-------|--------|--------|-------|-----|---------------|
| 1/2 Tons Capacity | | | | | | | | | | |
| AST-00.50-A | 0 - 3/4 | 10-3/4 | 6-11/16 | - | 1-3/4 | 6-3/16 | 1-5/8 | 2-1/2 | 1/2 | 10 |
| 1-1/2 Tons Capacity | | | | | | | | | | |
| AST-01.50-A | 0 - 3/4 | 13 | 8-1/2 | - | 2-1/2 | 7 | 2-9/16 | 3 | 5/8 | 20 |
| 3 Tons Capacity | | | | | | | | | | |
| AST-03.00-A | 0 - 1-1/2 | 19-1/4 | 12-1/2 | - | 3-3/4 | 11 | 3 | 4-5/8 | 3/4 | 50 |

Consult factory for possible larger capacities. SPECIFICATIONS ARE SUBJECT TO CHANGE WITHOUT NOTICE.

IN STOCK