

# Model NM

## Locking, Screw Type

The Model NM clamp (non-marring) is manufactured with smooth gripping surfaces to prevent marring when gripping stainless steel, copper, aluminum and other polished metal plates. Due to the variety of conditions that may exist in handling these plates, it is recommended that these clamps be used in pairs and attached to a chain or wire rope sling, supported by a spreader beam. The Model NM is supplied with stainless steel gripping surfaces and is available with steel or bronze upon request. The Model NM is not intended for use in transportation of plates using mobile equipment where shocking of the load may occur.



Non-marring with 90-degree turn only.

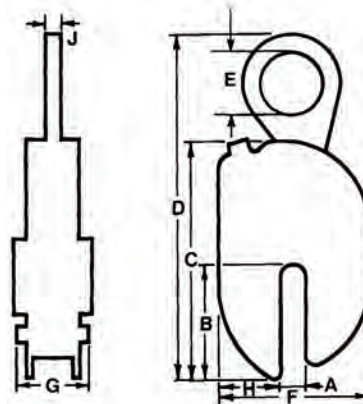
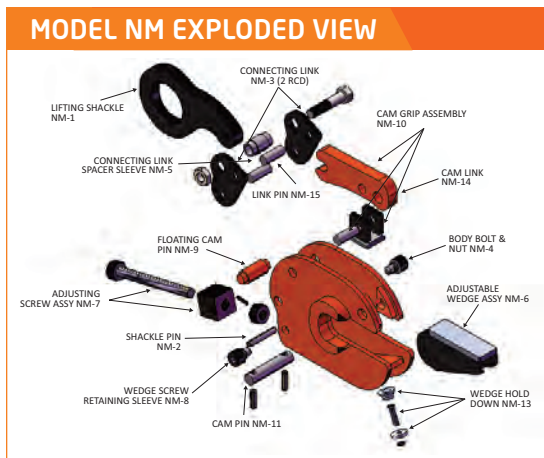

**Get the Latest Caldwell News** 

Follow us on LinkedIn to see what's going on at Caldwell. New product updates, interesting custom builds, industry news ... it's all there.

### MODEL NM SPECIFICATIONS (in inches)

Part Number	Plate Thickness A	B	C	Max. D	E	F	G	H	J	Weight (lbs.)
<b>1 Tons Capacity</b>										
NM-01.00-A	0 – 3/4	4-1/2	9-3/8	15-3/8	2-3/8	5-7/8	3-1/8	2-3/8	5/8	17
NM-01.00-B	3/4 – 1-1/4	4-1/2	9-3/8	15-3/8	2-3/8	6-3/8	3-1/8	2-3/8	5/8	19
NM-01.00-C	1-1/4 – 1-3/4	4-1/2	9-3/8	15-3/8	2-3/8	6-7/8	3-1/8	2-3/8	5/8	21
NM-01.00-D	1-3/4 – 2-1/4	4-1/2	9-3/8	15-3/8	2-3/8	7-3/8	3-1/8	2-3/8	5/8	23
<b>2 Tons Capacity</b>										
NM-02.00-A	0 – 15	5-1/8	10-1/16	16	2-5/8	6-3/4	3-3/4	2-7/8	5/8	23
NM-02.00-B	3/4 – 1-1/2	5-1/8	10-1/16	16	2-5/8	7-1/4	3-3/4	2-7/8	5/8	27
NM-02.00-C	1-1/4 – 2	5-1/8	10-1/16	16	2-5/8	7-3/4	3-3/4	2-7/8	5/8	28
NM-02.00-D	1-3/4 – 2-1/2	5-1/8	10-1/16	16	2-5/8	8-1/4	3-3/4	2-7/8	5/8	30
NM-02.00-E	2-1/4 – 3	5-1/8	10-1/16	16	2-5/8	8-3/4	3-3/4	2-7/8	5/8	33
<b>4 Tons Capacity</b>										
NM-04.00-A	1/4 – 1-1/2	5-3/8	12-1/8	18-9/16	2-15/16	7-3/4	4-1/2	2-15/16	1	45
NM-04.00-B	1-1/4 – 2-1/2	5-3/8	12-1/8	18-9/16	2-15/16	8-3/4	4-1/2	2-15/16	1	48
NM-04.00-C	1-3/4 – 3	5-3/8	12-1/8	18-9/16	2-15/16	9-3/4	4-1/2	2-15/16	1	50
NM-04.00-D	3 – 4-1/2	5-3/8	12-1/8	18-9/16	2-15/16	11	4-1/2	2-15/16	1	55
<b>8 Tons Capacity</b>										
NM-08.00-A	1-1/2 – 3-1/4	11	20-1/4	27-3/4	3-7/8	15-3/8	6-3/8	5-7/8	2	193
NM-08.00-B	1-3/4 – 3-1/2	11	20-1/4	27-3/4	3-7/8	15-5/8	6-3/8	5-7/8	2	195
NM-08.00-C	3 – 4-1/2	11	20-1/4	27-3/4	3-7/8	16-5/8	6-3/8	5-7/8	2	210
NM-08.00-D	4 – 5-1/2	11	20-1/4	27-3/4	3-7/8	17-5/8	6-3/8	5-7/8	2	225
<b>12 Tons Capacity</b>										
NM-12.00-A	2 – 4	11	20-1/4	27-3/4	3-7/8	16-1/8	7-7/8	5-7/8	2	200
NM-12.00-B	3-3/4 – 5-1/2	11	20-1/4	27-3/4	3-7/8	17-5/8	7-7/8	5-7/8	2	220
NM-12.00-C	4-1/2 – 6	11	20-1/4	27-3/4	3-7/8	18-1/8	7-7/8	5-7/8	2	240

Consult factory for possible larger capacities. SPECIFICATIONS ARE SUBJECT TO CHANGE WITHOUT NOTICE.