

Electric Chain Hoist

Single-Phase



Hoist Outline

Dual Voltage

All single-phase hoists come standard from the factory wired for 115V power supply. To use the hoist on 230V, internal wiring changes required.

Overload Protection (friction clutch)

Prevents operators from exceeding a hoist's rated lifting capacity.

Operating Conditions

Suitable for environments within -4° to +104° F. Recommended Humidity of 85% or less.

Electromagnetic DC brake

Standard DC brake is designed for a long service life.

Upper/Lower Limit Switches

Mechanical paddle limit switches. Stops the load chain from progressing past its safe limitation.

Pendant Control

Modern, ergonomic design. Mainline contactor, red emergency stop push button is standard on all pendants. Pendant Cord includes external strain relief.

Load Chain

Black Oxide Grade 80, case hardened FEC Japanese Chain.

Contacter Controlled

Chain Container

Included with all standard hoists.

Forged Swivel Hook-Notched

Top & Bottom hook rotates 360°. Hooks are notched to securely accommodate the heavy duty cast safety latches. (Fixed position top Hook on 5 ton)

Standard Voltage

115v/ 230v Single-Phase, 60 Hz

Ratings

Pendant: IP65

Hoist: IP55

Standard Lift

20 Ft (custom lengths available)

Standard Pendant Cord Length

17 Ft (custom lengths available)

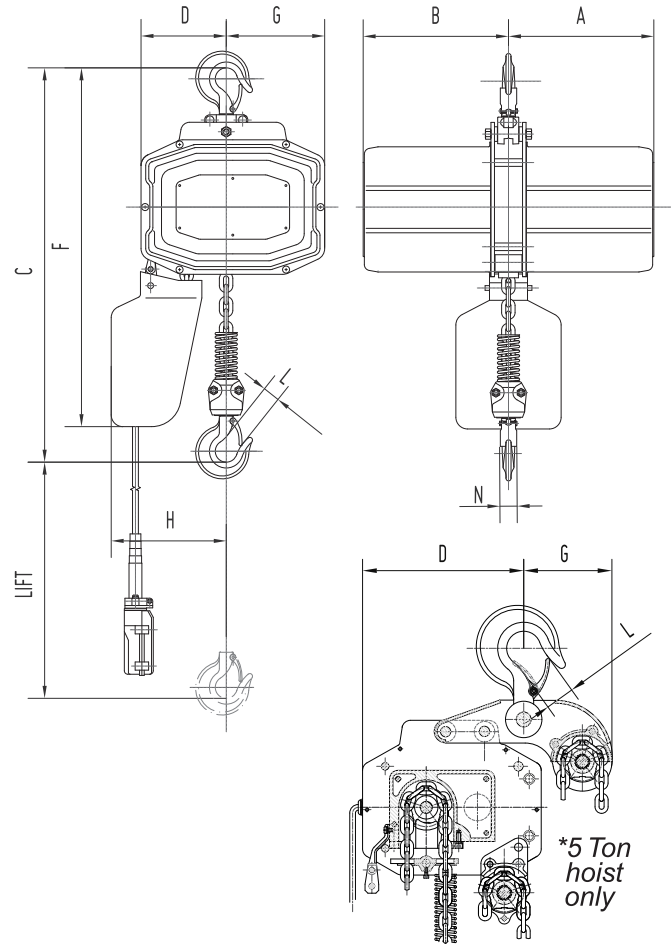

Standard Power Cord Length

15 Ft (custom lengths available)

Control Voltage

24v

Duty Cycle

40% ED

Chain Container

Canvas or plastic container included with all standard hoists.

Capacity Range

¼ – 5 Ton

Hoist Mounting

Rigid hook; manual trolley; motorized trolley

Product Code	Capacity	Standard Lift Height	Lifting Speed	Motor Output	Power Supply	Load Chain Size	Chain Fall Lines	Pendant Cord Length	Total Net Weight
	tons	ft	ft/min	Hp	Volts (1-Phase)	mm		ft	lbs
HH-B025	1/4	20	21	2	115/230	7.1	1	17	148
HH-B05	1/2	20	21	2	115/230	7.1	1	17	148
HH-B10	1	20	21	2	115/230	7.1	1	17	150
HH-B20	2	20	10.5	2	115/230	7.1	2	17	173
HH-B30	3	20	7	2	115/230	7.1	3	17	198
HH-B50	5	20	4.2	2	115/230	7.1	5	17	333

Product Code	Capacity	Head Room (C)	A	B	G	D	L	F	H	N	Rated Current (amps)	
	tons	in	in	in	in	in	in	in	in	in	@115v	@230v
HH-B025	1/4	21.5	10	10	7	6	1.47	31	8	0.73	14.2	7.1
HH-B05	1/2	21.5	10	10	7	6	1.47	31	8	0.73	14.2	7.1
HH-B10	1	21.5	10	10	7	6	1.47	31	8	0.73	14.2	7.1
HH-B20	2	29.1	10	10	7	6	1.65	34	9	0.83	14.2	7.1
HH-B30	3	31	10	10	4	8	1.69	38	11	0.9	14.2	7.1
HH-B50	5	37	10	10	7.75	12.25	1.75	50	13	1.89	14.2	7.1