

TILT MASTER - TM-60-AIR

APPROX WEIGHT: 851 lbs.
 DOES NOT INCLUDE WEIGHT OF POWER OR PACKAGING!!!

*** ANY ADDITIONS, DELETIONS, OR OMISSIONS MUST BE CORRECTED ON THIS DRAWING AS THIS DRAWING WILL BE CONSIDERED ALL INCLUSIVE ***
 ALL GRAPHICS PROVIDED ARE FOR REFERENCE ONLY. IF CERTAIN DIMENSIONS ARE CRITICAL PLEASE VERIFY THOSE DIMENSIONS WITH YOUR SALESPERSON

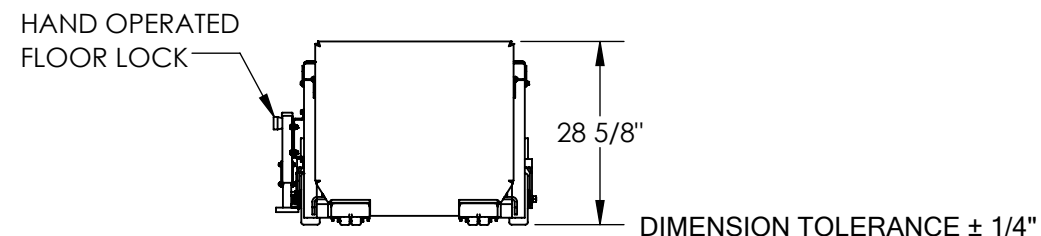
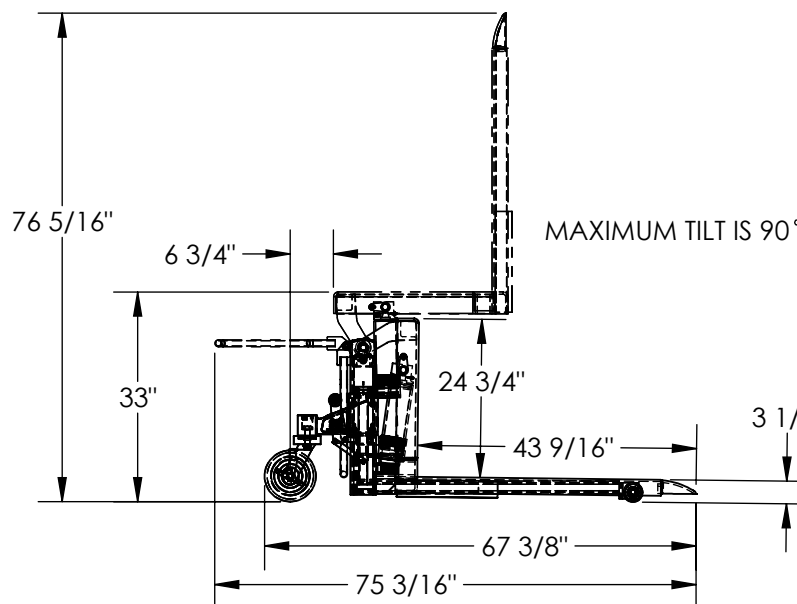
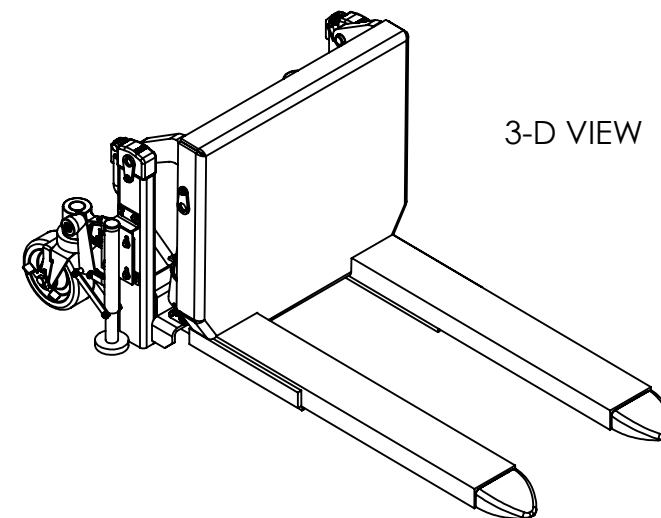
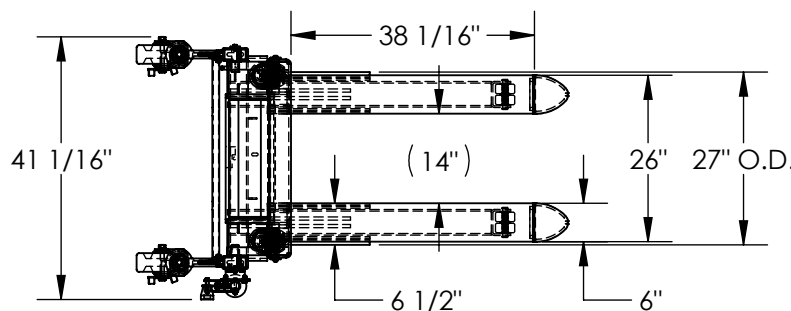

STANDARD FEATURES

MODEL NUMBER IS TM-60-AIR
 CAPACITY IS 6,000 lbs
 OVERALL WIDTH IS 41 1/16"
 OVERALL LENGTH IS 75 3/16"
 OVERALL HEIGHT IS 76 5/16"
 ROTATED HEIGHT IS 33"
 LEVEL HEIGHT IS 28 5/8"
 FORK WIDTH IS 6 1/2" (WITH STIFFENER)
 LOWERED FORK HEIGHT IS 3 1/2"
 USABLE FORK LENGTH IS 38 1/16"
 FORK ADJUSTMENT FIXED AT 27"
 INCLUDES HAND OPERATED FLOOR LOCK
 AIR/OIL POWERED:
 RECIPROCATING AIR
 POWERED HYDRAULIC
 15 CFM @ 100 PSI (1/4 GPM)
 FOOT TREADLE OPERATION
 DURABLE LIQUID PAINT BLUE FINISH

SPECIAL FEATURES

NONE

APPROVAL

I, THE UNDERSIGNED, AGREE THAT THE PRODUCT AS REPRESENTED SATISFIES DESIGN AND DIMENSION REQUIREMENTS. I ALSO ACKNOWLEDGE MY DUTY TO CONFIRM PRODUCT AND INSTALLATION COMPLIANCE WITH ALL APPLICABLE FEDERAL, STATE AND LOCAL REGULATIONS AND STANDARDS.
UNITS REQUIRING APPROVAL DRAWINGS OR MODIFIED ARE NON-RETURNABLE

[] As drawn [] As marked

Signed: _____ Date: _____

Printed Name: _____

LEAD TIME WILL START UPON RECEIPT OF SIGNED APPROVAL DRAWING

DISTRIBUTOR'S NAME:		P.O.#
VESTIL MANUFACTURING		X
DRAWN BY: MTS		DATE: 6/22/2015
REFERENCE: X		SCALE: 1:30
QUOTED LEAD TIME: X	QUOTE # X	FILE NAME: 38-007-039