

TURNTABLE W/ POWERED HEIGHT ADJUSTMENT - TT-N-24-LA

APPROX WEIGHT: 152.50 lbs.
DOES NOT INCLUDE WEIGHT OF POWER OR PACKAGING!!!

*** ANY ADDITIONS, DELETIONS, OR OMISSIONS MUST BE CORRECTED ON THIS DRAWING AS THIS DRAWING WILL BE CONSIDERED ALL INCLUSIVE ***
ALL GRAPHICS PROVIDED ARE FOR REFERENCE ONLY. IF CERTAIN DIMENSIONS ARE CRITICAL PLEASE VERIFY THOSE DIMENSIONS WITH YOUR SALESPERSON

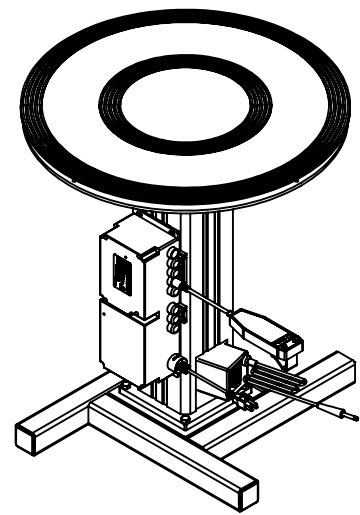
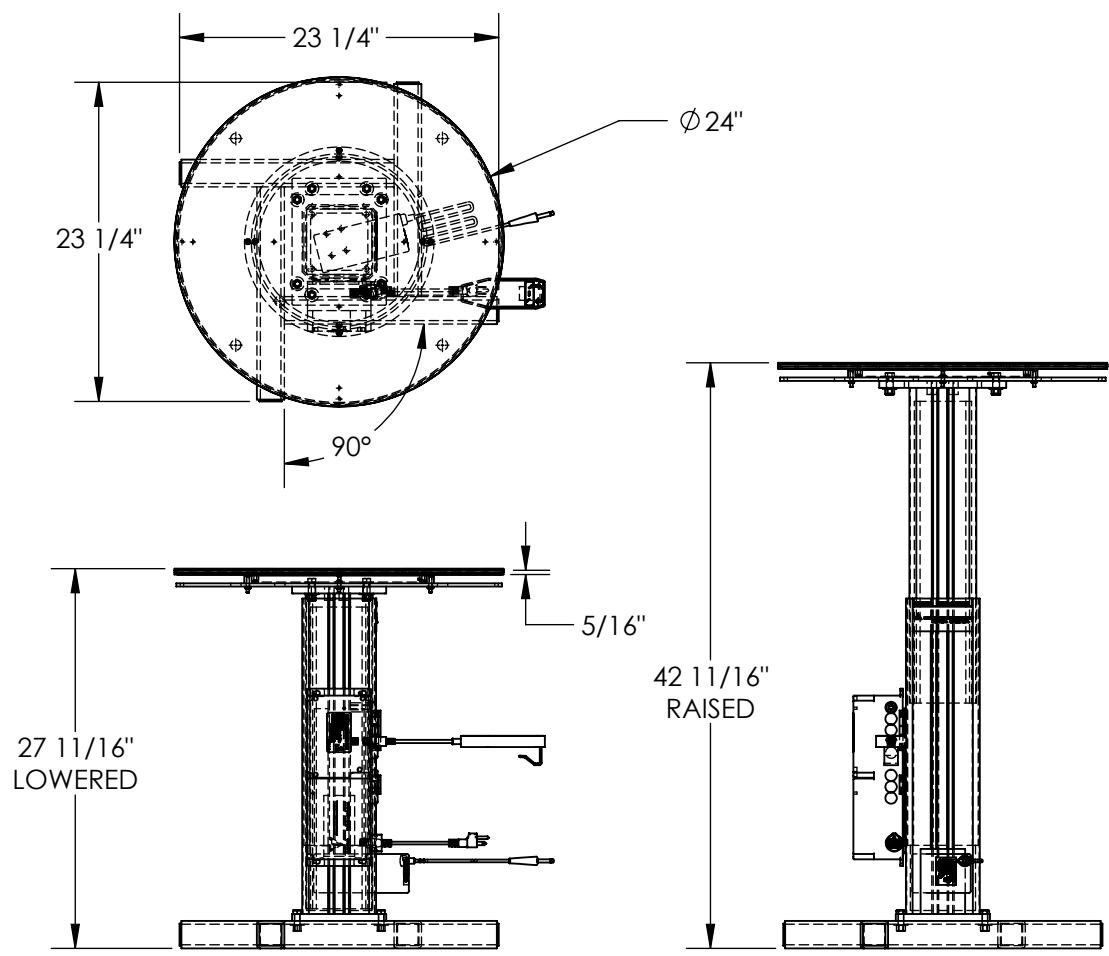

DIMENSION TOLERANCE ± 1/4"

STANDARD FEATURES

- MODEL NUMBER IS TT-N-24-LA
- UNIFORM CAPACITY IS 750 LBS.
- BASE WIDTH IS 23 1/4"
- BASE DEPTH IS 23 1/4"
- TURNTABLE DIAMETER IS Ø24"
- LOWERED HEIGHT IS 27 11/16"
- RAISED HEIGHT IS 42 11/16"
- LINEAR ACTUATOR POWERED HEIGHT ADJUSTMENT
- 5/16" TOP PLATE
- RUBBER COVER ON TOP PLATE
- BLUE LIQUID PAINT FINISH

SPECIAL FEATURES

NONE

POWER SPECIFICATIONS

- *DC (24V) POWER
- *HAND CONTROL
- *ON-BOARD CHARGER

I, THE UNDERSIGNED, AGREE THAT THE PRODUCT AS REPRESENTED SATISFIES DESIGN AND DIMENSION REQUIREMENTS. I ALSO ACKNOWLEDGE MY DUTY TO CONFIRM PRODUCT AND INSTALLATION COMPLIANCE WITH ALL APPLICABLE FEDERAL, STATE AND LOCAL REGULATIONS AND STANDARDS.

ANY MODIFIED UNITS ARE NON-RETURNABLE

[] As drawn [] As marked

Signed: _____ Date: _____

Printed Name: _____

LEAD TIME WILL START UPON RECEIPT OF SIGNED APPROVAL DRAWING

APPROVAL

| | |
|---|--|
| FOR INTERNAL USE ONLY PROJECT SIGN OFF | |
| SALES | |
| ENG. | |
| FAB. | |
| POWER | |

| | | |
|----------------------|--------------|------------------|
| DISTRIBUTOR'S NAME: | | P.O.# |
| VESTIL MANUFACTURING | | X |
| W.O.# | | X |
| DRAWN BY: | B.NOETHNAGEL | DATE: 10/26/2015 |
| REFERENCE: | X | SCALE: 1:14 |
| QUOTED LEAD TIME: | X | QUOTE # X |
| FILE NAME: | | 20-007-147 |