

KStrong® Kapture™ Elite 5-Point Full Body Harness, 3 D-Rings, MB Legs (ANSI)

KStrong® Kapture™ Elite 5-Point Adjust Full Body Harness with One (1) Dorsal D-Ring, Two (2) Side D-Rings and Mating Buckle Leg Closures (ANSI)

MODEL	SIZE	WEIGHT
UFH10231P(S-M)	Small to Medium	3.83 lbs. ± 0.02 lbs. (1737 gm ± 10 gm)
UFH10231P(M-L)	Medium to Large	3.96 lbs. ± 0.02 lbs. (1796 gm ± 10 gm)
UFH10231P(L-XL)	Large to X-Large	4.05 lbs. ± 0.02 lbs. (1837 gm ± 10 gm)

DESIGN

- One dorsal attachment D-ring for fall arrest.
- Adjustable Shoulder straps.
- Adjustable leg straps.
- Two side D Ring for work positioning

WEBBING

Material: Polyester
Width: 1.73 in. ± 0.04 in. (44mm ± 1mm)
Breaking Strength: 5000 lbs.

STITCHING THREAD

Material: High-tenacity polyester

METAL COMPONENT

Material: High Strength Steel.
Plating : Zinc Plated
Finish : Shotblasted

CAPACITY RANGE

ANSI: 130 - 310 lbs.; OSHA: 420 lbs.

RELEVANT STANDARDS

Meets or Exceeds ANSI Z359.11-2014

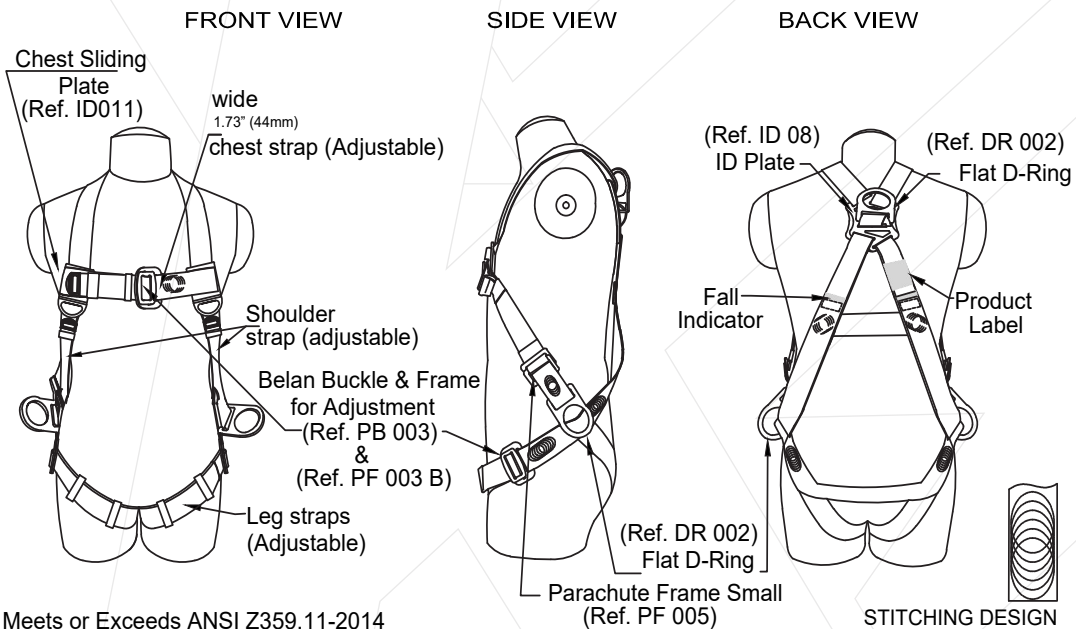

Meets or Exceeds ANSI Z359.11-2014